

GV-IPCAM 1.3M D/N Vandal Proof Dome



- 1.3 megapixel SONY progressive scan CCD
- Dual streaming support MJPEG and MPEG4
- Two way audio
- Digital I/O: 1 IN, 1 OUT
- Support both 12V DC and PoE
- Video Motion Detection reduces bandwidth and storage
- 3GPP/ISMA mobile application
- Privacy Mask
- Visual Automation

Providing detail not seen on conventional surveillance cameras, the GV-IP Camera 1.3M features a 1.3 megapixel CCD that delivers superb video image quality. Through the use of progressive scan CCD sensor, the GV-IP Camera 1.3M is able to reproduce ultra smooth video images of fast moving objects without any pixilated edges. With high definition up to 1280 x 960 and up to 4 times higher resolution than conventional VGA/ D1 cameras, the GV-IP Camera 1.3M allows users to monitor critical areas with greater detail than ever. Moreover, with simultaneous/dual video stream and support for compliant Power-over-Ethernet (PoE) which simplifies the cabling. It allows users to view both MJPEG images and MPEG-4 videos with improved efficiency while conserving valuable bandwidth.

In providing our customers with a more complete, cost-effective IP surveillance solution, our GV-IP Camera 1.3M can seamlessly integrate with our GV-NVR software system that comes with advanced monitoring and various other video management features. When connected with the GV-IP Camera 1.3M, Special web interface support functions such as privacy mask, visual automation, picture-in-picture (PiP) view and picture-and-picture (PnP) view are also made available for facilitating detail monitoring.

Progressive scan CCD captures the entire scene of a moving object at the same time. Even and odd fields are scanned simultaneously. It reproduces smooth video quality without pixilated edges.



It provides up to 4 times higher resolution than common VGA/D1 cameras.

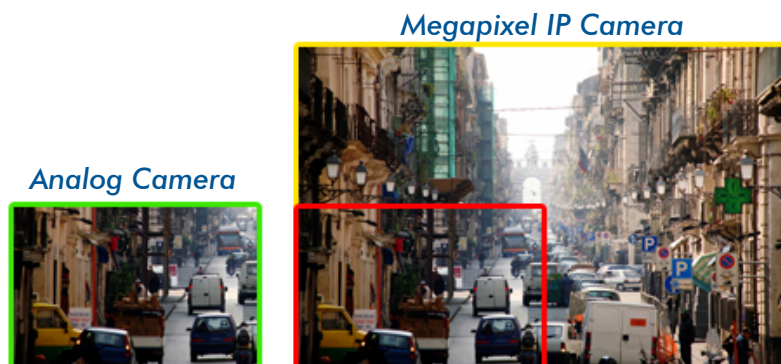

SPECIFICATIONS

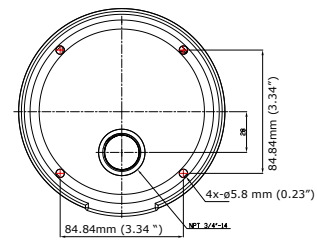
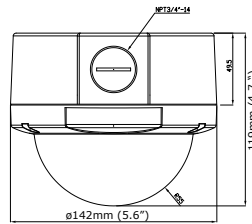
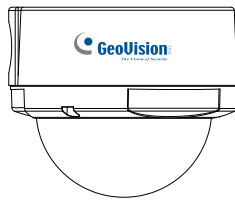

Camera		
Image Sensor	1/3" SONY progressive scan CCD	
Picture Elements	1280(H) x 960 (V), 1.3M CCD	
Resolution	700 TVL	
Minimum Illumination	0.02 lux @ F1.2	
Shutter Speed	1.5 ~ 1/1000 sec.	
White Balance	Manual / ATW (1500 ~ 15000K)	
Lens		
Max Aperture	Wide F1.4, Tele F2.9	
Lens Focal	f = 3.3~12 mm	
Angle of View	Wide end	Diagonal 125.7° / Horizontal 89.8 °
	Tele end	Diagonal 29.9 ° / Horizontal 23.9 °
Operation		
Video Codec	MPEG4 / MJPEG	
Video Streaming	Simultaneous MPEG4 and MJPEG video stream (dual stream) Selectable single stream (MPEG4 or MJPEG)	
Resolution	MPEG4 ASP: VGA, QVGA, CIF, QCIF MJPEG: 1280x960(4 VGA), VGA, QVGA, CIF, QCIF	
Frame Rate	MPEG4 30fps@VGA MJPEG 15fps@1280x960	
Image Setting	Auto Exposure, Auto White Balance, Brightness, Contrast, Sharpness, Gamma, Mono, Reverse, Rotate 180°, Flicker-less 50/60 Hz	
Audio Codec	G.726	
Digital Input	Dry Contact	
Digital Output	Photo relay output: 40mA, 5~12VDC	
Network		
Interface	10/100 Ethernet (RJ-45)	
Protocol	HTTP, TCP, UDP, SMTP, FTP, DHCP, NTP, UPnP, DynDNS, 3GPP/ISMA RTSP	
Power over Ethernet		
PoE Standard	IEEE 802.3af Power over Ethernet / PSE	
PoE Power Supply Type	End-Span	
PoE Power Output	Per Port 48V DC, 350mA. Max. 15.4 watts	
Mechanical		
Connectors	Power	3 pins terminal block, pitch 3.5 mm
	Ethernet	180D RJ-45 with LED
	Audio	3 pins terminal block, pitch 2.54 mm
	Digital I/O	4 pins terminal block, pitch 2.54 mm
LED Indicator	Power, Link, TX	
Mechanical IR Cut Filter	Yes	
General		
Operating Temperature	-10°C ~ 50°C / 14°F ~ 122°F	
Humidity	10% to 90% (no condensation)	
Weather Proof	IP66 standard	
Power Source	DC12V / PoE	
Power Consumption	4.2 W (max. 350mA DC 12V)	
Certificate	CE, FCC, RoHS compliant	
Dimension	ø 142 x 119mm / 5.6 x 4.7 in	
Weight	1 kg / 2.2 lbs	
Web Interface		
Installation Management	Web-based configuration	
Maintenance	Firmware upgrade through Web Browser	
Access from Web Browser	Camera live view, video recording, change video quality, zoom in/out, bandwidth control, image snapshot, digital I/O control, audio, Picture in Picture, Picture and Picture, Privacy Mask, Visual Automation	
Applications		
Network Storage	GV-NVR, GV-MultiCam	
3G Mobile Phone	Built-in player for 3GPP/ISMA	
Live Viewing	MultiView	
CMS Server support	Control Center, CenterV2, VSM	

OPTIONS

Optional devices can expand your GV-IP Camera's capabilities and versatility. Contact your dealer for more information.

GV-Relay V2	Working with this module, GV-IP Camera can drive the loads of relay outputs over 5V.
-------------	--